



INSTALLATION



LIGHTED LOWER SADDLEBAG ACCENTS 1564

FITS: '93-UP TOURING MODELS WITH HARD BAGS (DRESSER, ROAD KING, ROAD GLIDE, STREET GLIDE)

PARTS INCLUDED

- 1 Right Lighted Saddlebag Accent
- 1 Left Lighted Saddlebag Accent
- 1 Hardware Kit Including:
 - 5 Alcohol Pads
 - 6 Cable Ties
 - 1 Dielectric Grease Pack
 - 6 T-Tap Female Quick Slide Scotchlocks
 - 6 Male Scotchlocks
 - 1 Wiring Pigtail
 - 2 Warning Stickers
 - 8 Cord Keepers
 - 2 Bumpers
- 1 Installation Instructions

Please read and understand entire instructions before starting installation.

THANK YOU FOR CHOOSING KÜRYAKYN!

IN ORDER TO PROTECT YOU AND OTHERS FROM POSSIBLE INJURY AND/OR PROPERTY DAMAGE OR LOSS, PLEASE PAY CLOSE ATTENTION TO ALL INSTRUCTIONS, WARNINGS, CAUTIONS AND ATTENTION NOTES REGARDING THE USE AND CARE OF THIS PRODUCT.

WARNING! THIS INDICATION ALERTS YOU TO THE FACT THAT IGNORING THE CONTENTS DESCRIBED HEREIN CAN RESULT IN POTENTIAL DEATH OR SERIOUS INJURY.

CAUTION! This indication alerts you to the fact that ignoring the contents described herein can result in potential injury or material damage.

ATTENTION! This indication alerts you to the fact that ignoring the contents described herein may negatively affect product performance and functionality.

TOOLS SUGGESTED

Set of combination wrenches, warm soapy water and a clean rag, straight edges (rulers, paint sticks, etc.), masking tape, wire strippers, test light.

STRICTLY OBSERVE THE FOLLOWING GUIDELINES IN ORDER TO USE THE PRODUCT PROPERLY AND AVOID POTENTIALLY DANGEROUS ACCIDENTS.

PROCEDURE

STEP 1 Read and understand all steps in the instructions before starting the installation. Park the motorcycle on a hard, level surface; turn off the ignition and allow the engine to cool.

-cont.-

CUSTOMER SERVICE

877.370.3604 (toll free)

INSTALLATION QUESTIONS

techsupport@kuryakyn.com
or call 715.247.2983

LIMITED WARRANTY

Kuryakyn warrants that any Kuryakyn products sold hereunder, shall be free of defects in materials and workmanship for a period of one (1) year from the date of purchase by the consumer excepting the following provisions:

- Kuryakyn shall have no obligation in the event the customer is unable to provide a receipt showing the date the customer purchased the product(s).
- The product must be properly installed, maintained and operated under normal conditions.
- Kuryakyn makes no warranty, expressed or implied, with respect to any gold plated products.
- Kuryakyn shall not be liable for any consequential and incidental damages, including labor and paint, resulting from failure of a Kuryakyn product, failure to deliver, delay in delivery, delivery in non-conforming condition, or for any breach of contract or duty between Kuryakyn and a customer.
- Kuryakyn products are often intended for use in specific applications. Kuryakyn makes no warranty if a Kuryakyn product is used in applications other than intended.
- Kuryakyn electrical products are warranted for one (1) year from the date of purchase by the consumer. Components of Kuryakyn products containing L.E.D.s will be warranted for defects in materials and workmanship for 3 years from the date of purchase.
- Kuryakyn makes no warranty of any kind in regard to other manufacturer's products distributed by Kuryakyn. Kuryakyn will pass on all warranties made by the manufacturer and where possible, will expedite the claim on behalf of the customer, but ultimately, responsibility for disposition of the warranty claim lies with the manufacturer.

ABOUT OUR CATALOG

You'll find all our innovations for H-D, GL and Metric Cruisers in our annual catalogs. Order online today—select the "CATALOGS" icon. Each Kuryakyn® product comes with a Proof-of-Purchase good for a complimentary catalog. Details in packaging.

Be sure to ask your local dealer about other Kuryakyn® products, the motorcycle parts and accessories designed for riders by riders.

©2005 Kuryakyn USA® All Rights reserved.



WARNING! YOU WILL BE WORKING AROUND THE ENGINE AND EXHAUST SYSTEM DURING INSTALLATION. ENSURE THAT THE ENGINE AND EXHAUST SYSTEM HAVE FULLY COOLED TO PREVENT INJURY.

STEP 2 Remove the saddlebags from the motorcycle and set them on a clean rag on a stable surface.

CAUTION! Avoid damage to the motorcycle. Protect painted surfaces with a soft cloth or blanket.

STEP 3 Clean the saddlebags with warm soapy water and a clean rag; rinse and allow them to dry.

STEP 4 Refer to PIC. 1 to determine the left accent.

STEP 5 Lay the left trim piece on the bottom of the left saddlebag.

STEP 6 Using the straight edges on the side and front of the saddlebag as shown in PIC. 2, line the edges of the accent up with the straight edges.

STEP 7 Once the location of the accent piece has been determined on the saddlebag, mark several locations along the edge of the accent with masking tape for points of reference as shown in PIC. 3.

STEP 8 Remove the accent piece and clean the bottom of the saddlebag using an included alcohol-cleaning pad and let the area dry.

ATTENTION! Ensure the area of installation is free of grease, oil, dirt or other debris to ensure proper adhesion. Küryakyn WILL NOT warranty any parts lost due to improper installation.

ATTENTION! The adhesive will not bond correctly if applied at temperatures less than 50° F. Do not attempt this installation in temperatures less than 50° F.

STEP 9 Using the back of your fingernail, rub the backing of the adhesive pads on the accent to activate the catalyst.

STEP 10 Remove the adhesive backing and place the accent piece in position, lining the edges up with the masking tape reference points.

STEP 11 Press and hold in place for one (1) minute, full bonding strength will occur in 24 hours.

STEP 12 Remove the masking tape.

STEP 13 Using the back of your fingernail, rub the adhesive backing of the bumper; remove the backing and install on the front corner of the saddlebag as shown in PIC. 4.

STEP 14 Determine a routing pattern for the wires from the accent along the inner portion of the saddlebag. The wires need to be routed so that they are away from extreme heat, moving parts or pinch points. PIC. 5 shows a suggested routing for the wires.

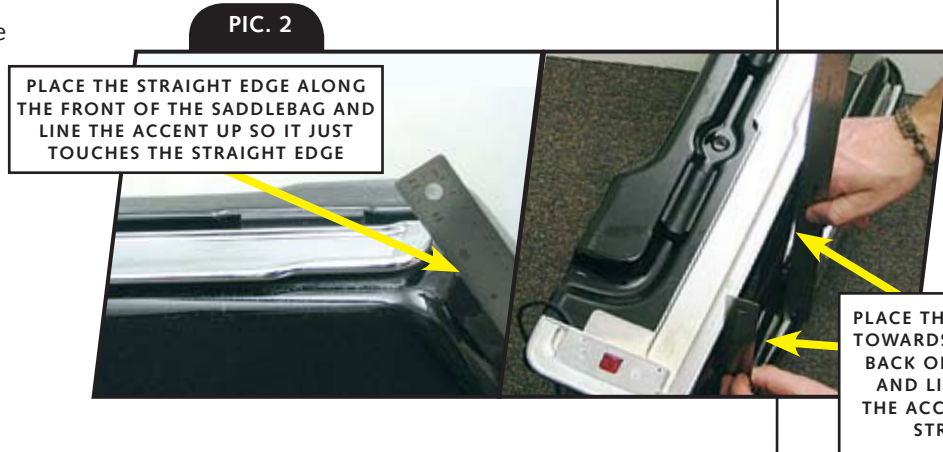
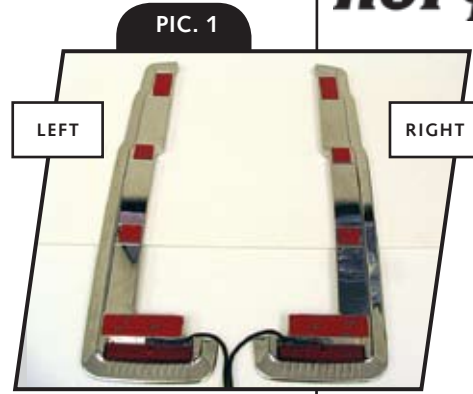

PLACE THE STRAIGHT EDGE ALONG THE FRONT OF THE SADDLEBAG AND LINE THE ACCENT UP SO IT JUST TOUCHES THE STRAIGHT EDGE

PLACE THE STRAIGHT EDGES TOWARDS THE MIDDLE AND BACK OF THE SADDLEBAG AND LINE THE EDGE OF THE ACCENT UP WITH THE STRAIGHT EDGE

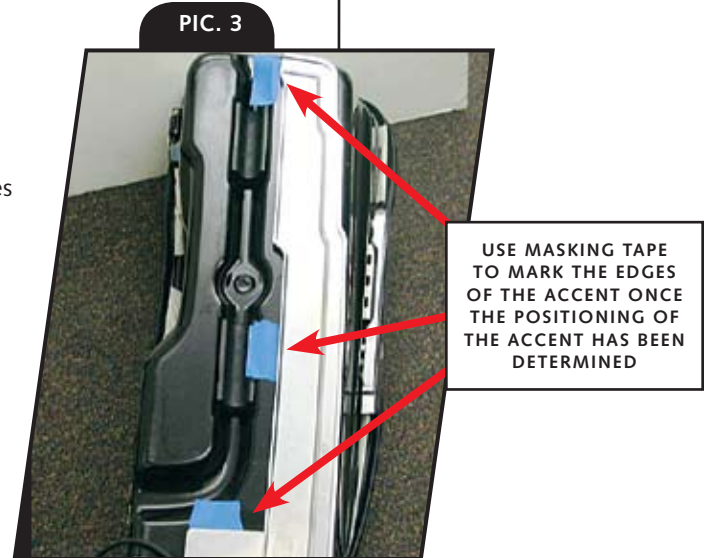

USE MASKING TAPE TO MARK THE EDGES OF THE ACCENT ONCE THE POSITIONING OF THE ACCENT HAS BEEN DETERMINED

NOTE: These locations are only suggested points to place the cord keepers & wires. You may need to place them in different locations for proper clearance.

STEP 15 Referring to PIC. 5, clean the highlighted areas (or the areas you choose to mount the cord keepers) with the included alcohol cleaning pad and allow the areas to dry.

STEP 16 Using the back of your fingernail, rub the adhesive backing on the cord keepers to activate the catalyst. Remove the adhesive backing, press and hold the cord keepers in place for one (1) minute, full bonding strength will occur in 24 hours.

ATTENTION! Secure all wiring away from any moving parts, pinch points or extreme heat. Küryakyn **WILL NOT** warranty any electrical component that fails due to pinched, crimped, broken, abraded, melted or frayed wires.

STEP 17 Place the wires from the accent in the cord keepers, and then close the keepers, ensuring that they snap closed.

STEP 18 Reinstall the left saddlebag on the motorcycle.

STEP 19 Repeat STEP 4 through STEP 18 for the right side.

STEP 20 Remove the seat from the motorcycle and locate the main taillight harness as shown in PIC. 6.

NOTE: On '93-'96 Models, it will be necessary to hard wire the lights, skip to STEP 27 under the wiring procedure for '93-'96 Models section.

STEP 21 Disconnect the wiring harness; place a small amount of dielectric grease on the 8-pin connections from the main taillight wiring harness and plug the pigtail into the ends of the main taillight harness.

NOTE: If there is a run-turn-brake controller installed, the pigtail harness needs to be installed upstream (in front) of the controller.

ATTENTION! Küryakyn recommends the use of dielectric grease on electrical connections.

STEP 22 Route the wires from the saddlebags under the seat, use the included cable ties to secure them away from pinch points, extreme heat or moving parts.

STEP 23 Apply a small amount of dielectric grease to the connections from the accent pieces.

STEP 24 Plug the wires from the accent into the 3 pin pigtails from the main pigtail harness.

STEP 25 Turn the ignition on and test to make sure that the lights function as both running lights and brake lights.

STEP 26 Place the warning stickers on the inside of the bags as shown in PIC. 7 to serve as a reminder to prevent the wires from being damaged when the saddlebags are removed from the motorcycle.

ATTENTION! It is the installer's responsibility to ensure that all of the fasteners (including pre-assembled) are tightened before operation of the motorcycle. Küryakyn will not warranty components lost due to improper installation. Periodic maintenance may be required.

-cont.-

Küryakyn[®]

PIC. 4



PLACE BUMPER ON THE FRONT CORNER OF SADDLEBAG

PIC. 5



PIC. 6



MAIN TAILLIGHT WIRING HARNESS

PIC. 7



PAGE

3

WIRING PROCEDURE FOR '93-'96 MODELS

STEP 27 Cut the three-pin pigtails from the main pigtail harness as close to the connection point as possible (shown in [PIC. 8](#)).

STEP 28 Using wire strippers, remove a small amount of insulation from the cut ends of the wires.

STEP 29 Insert the exposed end of one wire into a male scotchlock and crimp the end making sure that the wire is secure, as shown in [PIC. 9](#)

STEP 30 Repeat STEP 29 for the rest of the wires from the 3-pin pigtails.

STEP 31 Expose the main taillight wiring harness's wires.

STEP 32 Place two female T-Tap connectors over the black, red and blue wires in the main taillight wiring harness; close them, ensuring that the tabs are engaged as shown in [PIC. 10](#).

STEP 33 Place a small amount of dielectric grease on the female T-Tap connectors; insert the male spade connectors from the black wires into the female T-Tap connectors that were installed on the black wires in the taillight harness.

STEP 34 Repeat STEP 33 for the red and blue wires, connecting the red wires to the red wire and the blue wires to the blue wire.

ATTENTION! Kuryakyn recommends the use of dielectric grease on electrical connections.

STEP 35 Route the wires from the saddlebags under the seat, use the included cable ties to secure them away from pinch points, extreme heat or moving parts.

STEP 36 Apply a small amount of dielectric grease to the connections from the accent pieces.

STEP 37 Plug the 3-pin connector from the accent into the 3 pin pigtails that were hard wired to the taillight harness.

STEP 38 Turn the ignition on and test to make sure that the lights are function as both running lights and brake lights.

STEP 39 Place the warning stickers on the inside of the bags as shown in [PIC. 7](#) to serve as a reminder to prevent the wires from being damaged when the saddlebags are removed from the motorcycle.

ATTENTION! It is the installer's responsibility to ensure that all of the fasteners (including pre-assembled) are tightened before operation of the motorcycle. Kuryakyn will not warranty components lost due to improper installation. Periodic maintenance may be required.

Ride On!

Kuryakyn[®]

PIC. 8

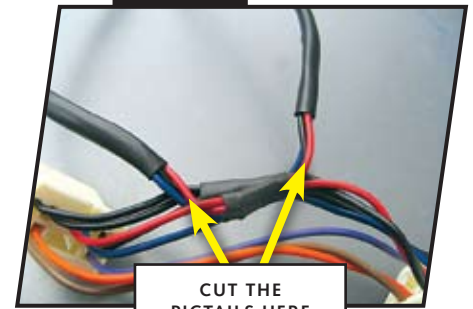

CUT THE PIGTAILS HERE

PIC. 9

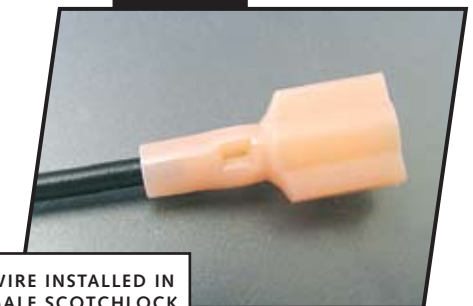

WIRE INSTALLED IN MALE SCOTCHLOCK

PIC. 10



FEMALE T-TAPS INSTALLED ON WIRE

PAGE

4